

Mi-Flues

UK's No.1 Flue & Chimney Specialist

MF4

“Triplelock”

FLEXIBLE LINER

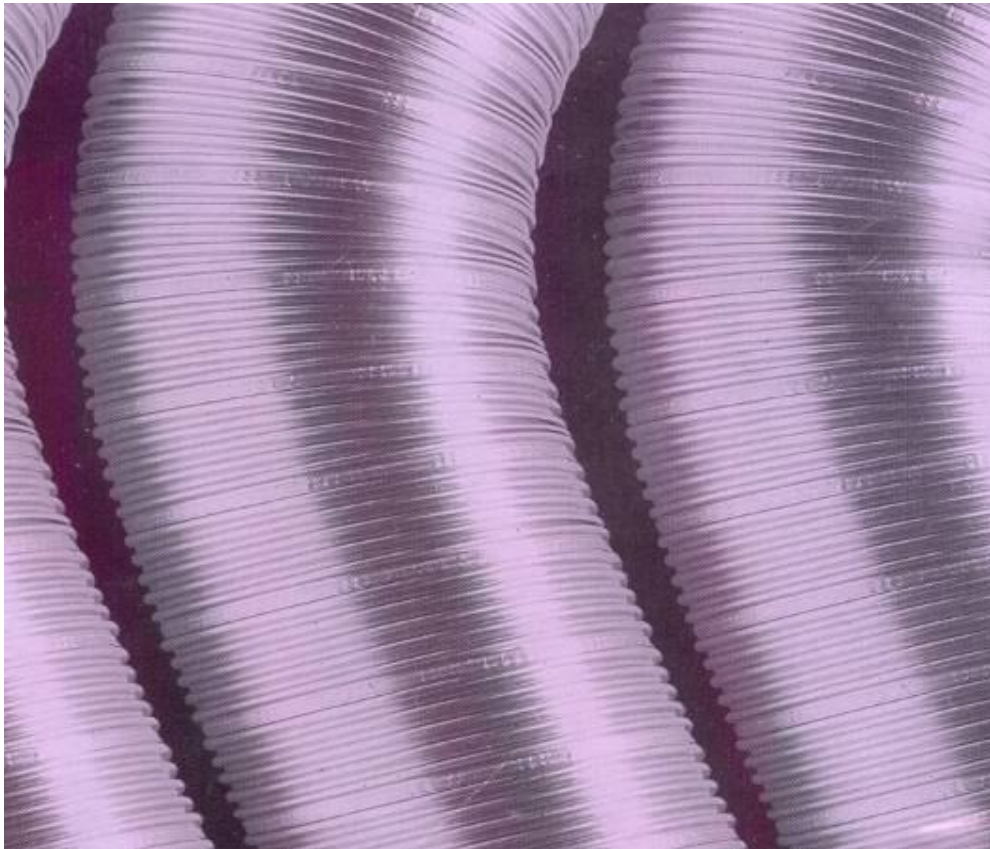

Mi-Flues Limited

Spiro House, Cocker Avenue, Poulton Business Park, Poulton-le-Fylde, Lancashire FY6 8JU
Telephone +44 (01253) 884972, Fax +44 (01253) 893752
Website: www.mi-flues.com, email: sales@mi-flues.com



MF4 "Triplelock" FLEXIBLE LINER

MF4 "Triplelock" flexible liner is designed for use with gas and 28-second oil fired appliances, and designed to accommodate temperatures not exceeding 260°C.

Available in ten diameters, ranging from 100mm to 350mm. Manufactured in a single skin of 316 S11 stainless steel. It has a roll and crimped seam featuring a triple locking process. It has an embossed identification of "BS715:1993 MIF" on diameters 100mm, 125mm and 150mm.

APPROVALS

MF4 has been assessed to BS715 :1993, and diameters 100mm, 125mm and 150mm are Kitemarked to that standard.

MF4 has an identification of "BS715:1993 MIF" which is indelibly printed on each seam of the liner.

The other diameters are manufactured to an identical specification. All MF4 is manufactured under the same ISO 9002 – 1987 conditions.

KITEMARK LICENSE No. **KM 40323**



BS 715:1993.

DESIGN & SPECIFICATION

MF4 "Triplelock" is manufactured from a continuous strip of high quality 316 grade stainless steel. Grade: 316S11 – low carbon stainless steel. Gauge: 0.1mm - tolerance -0, +0.01.



MF4 "Triplelock" is jointed by a dovetail folded triplelock seam, locked in three planes with a knurled seam to provide excellent cross sectional strength. The products has five convolutions between each seam and is identified by the embossed marking "BS715:1993 MIF" around each seam joint.

MF4 "Triplelock" has excellent cross sectional strength with a high resistance to damage. It is virtually impossible to unwind and can withstand prolonged high temperatures without distortion.

MF4 "Triplelock" is available in precut packs for diameters 100mm and 125mm. Each pack contains a cut length of liner up to 14m, a terminal and clamp plate. These are packed in a polythene bag.

Please refer to the table below for full options available.

DIAMETER	DRUM	PACK
100mm	50m	6m – 14m
125mm	50m	6m – 14m
150mm	42m	-
180mm	36m	-
200mm	30m	-
250-400mm	-	Up to 10m

APPLICATION

MF4 "Triplelock", or any other flexible liner, is not permitted by Building Regulations to be used as a substitute for clay or concrete liners in any new masonry chimney construction.

MF4 "Triplelock" is designed to be used ONLY inside a chimney as a retrofit liner, and for connection to combustion appliances. Where the liner serves either a fan powered gas fired appliances or oil appliance it is recommended that the annular space be back-filled with a dry insulating medium.

All diameters up to 200mm should be used in one continuous length. Where larger diameters require a length, which cannot be achieved in one continuous run, a stainless steel Joiner is available.

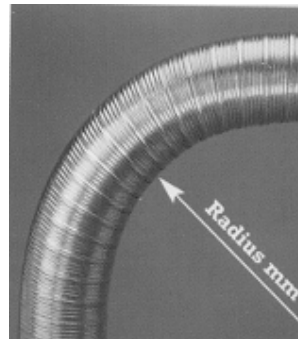

The maximum bending radius for MF4 "Triplelock" is 3 x diameter.

100mm – 300mm
125mm – 375mm
150mm – 450mm
180mm – 540mm
200mm – 600mm
250mm – 750mm
300mm – 900mm
350mm – 1050mm
400mm – 1200mm

ACCESSORIES



GC1 Economy Terminal

100Ø 4-4-C
125Ø 4-5-C
150Ø 4-6-C



GCL Economy Terminal

180Ø4-7-C
200Ø4-8-C
250Ø4-10-C



Clamp Plate 2-piece

100Ø 4-4-P
125Ø 4-5-P
150Ø 4-6-P

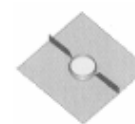

Clamp and Plate

180Ø 4-4-P
200Ø 4-5-P
250Ø 4-6-P



Debris Plate

100Ø 4-4-DP
125Ø 4-5-DP
150Ø 4-6-DP



Cast Ali Terminal

100Ø4-4-CT
125Ø4-5-CT
150Ø4-6-CT



Nose Cone

100Ø 4-4-NC
125Ø 4-5-NC
150Ø 4-6-NC
180Ø 4-7-NC
200Ø 4-8-NC
250Ø 4-10-NC

GAS FLUE BOXES



Flue Gas Collector

For gas radiant fires to BS5258: Part 5
125Ø 4-FGCS
125Ø 4-FGCC

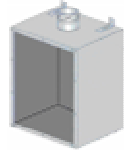

Recessed Flue Box

For gas radiant fires to BS5258: Part 5
125Ø 4-SFB

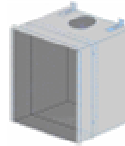

Back Boiler Flue Box

For back boilers with gas fires to BS5258: Part 8
125Ø 8-BBFB



Sheffield Flue Box

For back boilers with gas fires to BS5258: Part 5
Inc. Valor Firelite
125Ø 8-SHEF

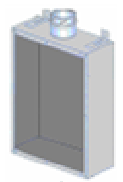

Standard Flue Box

For gas radiant fires to BS5258: Part 5
125Ø 4-SFB

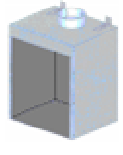

ILFE Flue Box

For gas radiant fires to BS5258: Part 16
125Ø 4-ILFE

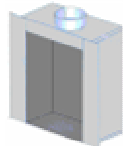

VMF Flue Box

For fires to BS5258: Part 5
Inc. Valor Firelite
125Ø 8-VMFS

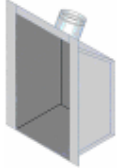

VISA Flue Box

For gas radiant fires to BS5258: Part 5
125Ø 4-VISA

FAQ

Can anybody install a flue liner?

Connection to an appliance, which is not connected to the fuel supply, should be carried out by a competent person. However, connection to an appliance that is connected to the fuel supply **MUST** be carried out by a CORGI (Gas) or OFTEC (oil) registered installer.

Can flue liner be installed anywhere?

No. Flue Liner **MUST** be installed inside a masonry brick chimney.

Is there a correct way up to install the flue liner?

No. MF4 "Triplelock" can be installed either way up.

The existing chimney has a flexible flue liner fitted, connected to an old gas fire. If the fire was to be changed can the liner be reused for the new appliance?

Yes. Providing the diameter and type flue liner is suitable for the new appliance, the installer has inspected the liner and is satisfied that the condition of the liner is good. However, as the lifespan of the previous appliance and liner is likely to be unknown, it is strongly recommended that old liner is removed, the chimney swept, and a suitable new liner installed.

Can MF4 "Triplelock" be used on condensing appliances?

No. Because the internal surface profile is convoluted and can hold aggressives caused by the flue gases, which will attack and eventually corrode the stainless steel.

The chimney to be lined is very tall, can lengths of flue liner be joined?

MF4 "Triplelock" **MUST** be installed in continuous lengths without joints. Mi-Flues can supply liner in specific lengths on drums or in pack form upon request.

What is the life expectancy and are there any warranties on MF4?

Under normal operating conditions and providing the liner is installed correctly, it should the lifetime of the appliance, which is normally 10 to 12 years. MF4 carry a ten-year conditional warranty.

Will the flue liner be OK to use after a chimney fire?

No. The liner could be damaged and **MUST** be inspected by a suitably qualified person (NACS/NACLE member)

INSTALLATION

Preparation

The chimney must be inspected for deterioration and if necessary, any remedial work should be carried out. The chimney should be swept, preferably by a member of NACS (National Association of Chimney Sweeps) or a suitable qualified chimney sweep.

Handling

Care should be taken not to knock or bend the product further than the flexibility will allow so as avoiding stressing which might buckle or puncture the product. (See the maximum bending radius chart).

Gloves should be worn to avoid injury on any sharp edges exposed at each end of the liner. Take particular care when uncoiling the liner, as it may try to spring out of the pack.

Installation



Attach the draw-cord to the *nose cone*. Use self-tapping screws to secure the *nose cone* to the end of the liner. Lower it into the chimney from the top, if necessary gently pulling from below using the draw-cord. When the lower end position has been determined remove the cone.



If necessary cut the liner to length, and secure the liner at the chimney top using the *clamp plate*.

Ensure 75mm of the liner projects above the *clamp plate*, so that the *terminal* can be located and secured.

Secure and seal the liner to a *debris plate*, which closes off the appliance recess. Make sure that as little of the liner protrudes below the plate. Alternatively, the end of the liner can be sealed into the appliance flue pipe or socket on Mi-Flues *Flue Gas Collector*, or *Flue Box* with non-combustible rope and/or fire cement.



Terminate the flex by securely fitting the chosen Mi-Flues terminal to the projecting section of the liner

Apply suitable acid resistant cement as a seal and weather proof render.

PACKAGING DETAILS & CODES

PACKS

100Ø x 6m	4-4-6	125Ø x 6m	4-5-6
100Ø x 7m	4-4-7	125Ø x 7m	4-5-7
100Ø x 8m	4-4-8	125Ø x 8m	4-5-8
100Ø x 9m	4-4-9	125Ø x 9m	4-5-9
100Ø x 10m	4-4-10	125Ø x 10m	4-5-10
100Ø x 11m	4-4-11	125Ø x 11m	4-5-11
100Ø x 12m	4-4-12	125Ø x 12m	4-5-12
100Ø x 13m	4-4-13	125Ø x 13m	4-5-13
100Ø x 14m	4-4-14	125Ø x 14m	4-5-14

DRUMS

100Ø x 50m	4-4-50	200Ø x 30m	4-8-30
125Ø x 50m	4-5-50	250Ø x 10m	4-10-10
150Ø x 42m	4-6-42	300Ø x 10m	4-12-10
180Ø x 36m	4-7-36	350Ø x 10m	4-14-10

TYPICAL INSTALLATION

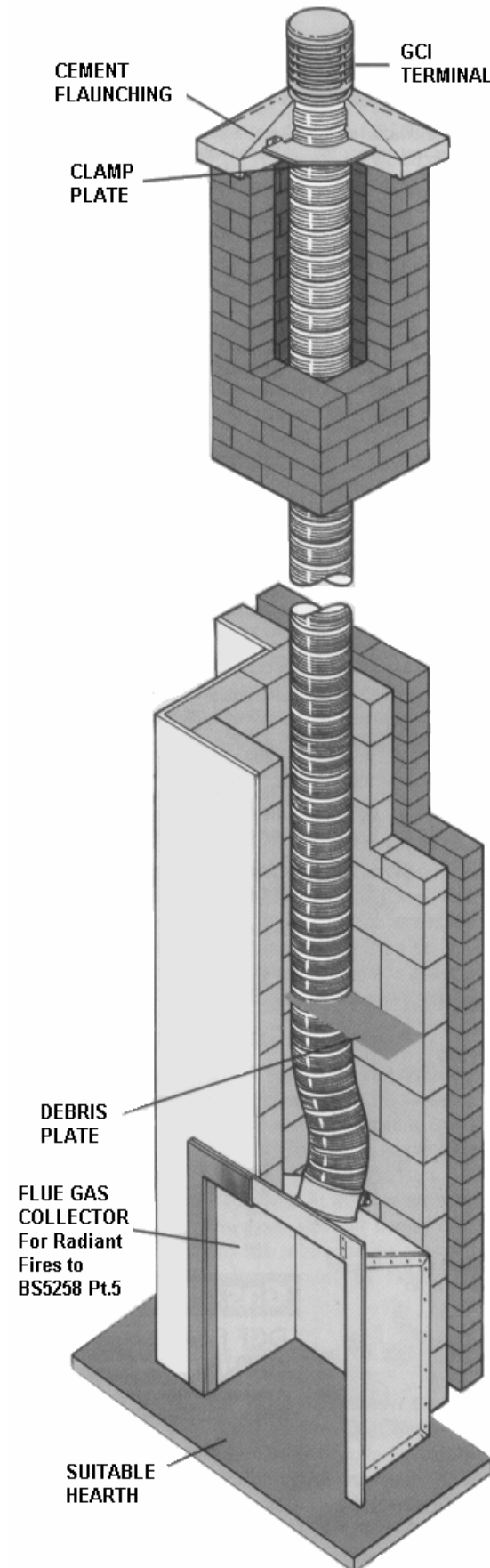

FLUE SIZE SELECTION CHART

	100Ø	125Ø	150Ø	180Ø - 350Ø
Gas – Atmospheric Boiler				
Input up to 25kW	•			
Input 25kW to 40kW		•		
Input 40kW to 60kW			•	
Gas – Industrial Boiler				
Input 50kW to 70kW				•1
Gas Fires				
Radiant to BS5258 Part 5		•		
Inset to BS5258 Part 16		•2		•2
Back boiler to BS5258 Part 8		•		
Gas Water Heaters				
Input up to 25kW	•			
Input 25kW to 55kW		•		
Input 55kW to 60kW			•	
Input over 60kW				•1
Gas Warm Air Unit				
Input up to 18kW	•			
Input 18kW to 35kW		•		
Input 35kW to 60kW			•	
Input over 60kW				•1
Gas Stove / Cooker	•1	•1	•1	•1
Kerosene 28sec Class C2				
Heating Boiler				
Output up to 25kW	•			
Output 25kW to 45kW		•		
Output 45kW to 70kW			•	
Kerosene Stove / Cooker	•3	•3	•3	
Kerosene Water Heater				
Input up to 41kW			•	
Kerosene Visual Effect Stove				
Output up to 17kW	•3	•3		

Notes. 1 Subject to manufacturer's input rating and chimney height.
 2 Subject to appliance manufacturers testing criteria.
 3 Subject to manufacturer's output rating and chimney height.

Mi-Flues

UK's No.1 Flue & Chimney Specialist

Spiro House
 Cocker Avenue
 Poulton Business Park
 Poulton-le-Fylde
 Lancashire FY6 8JU

Telephone +44 (01253) 884972
 Fax +44 (01253) 893752
 Website: www.mi-flues.com
 email: sales@mi-flues.com

Mi-Flues has adopted a policy of continuous product review, and in the interests of development and improvement the Company reserves the right to vary the appearance and performance of any of its products without prior notice.